

**SOMMER**  
Home Automation

garage door operators



# duo vision



- separate control unit with integrated interior push-button



## Optional designer control housings

- other control unit housings with different finishes (ask about further designs)



Rose wood  
item no. 3118V001



Carbon  
item no. 3118V000



**Sommer's  
unique solution –  
quick to install,  
no mess and  
no hassle**

## Benefits of the duo operation system:

- **Control unit housing**
  - the separate control unit will plug into an existing wall socket, thus avoiding the need to install new wiring or sockets.
  - light cover which can be moved easily.
  - the control board is inside the housing and protected against dirt and damage.
  - reset and memory button is easily accessible.
- **Accident prevention**
  - electronic regulated force measurement with DPS - dynamic power system
- **Regulated soft run**
  - no loss of force
- **Low power consumption**
  - due to toroidal transformer (in duo vision 650 / 800)
- **Connection**
  - for light barrier, warning light and TorMinal
- **Universal power supply**
  - front and rear of the c-rail

### duo vision 500

item no. 3000V000

### duo vision 650

item no. 3010V000

### duo vision 800

item no. 3020V000

### track unit for duo vision operators

travel length 2600 mm

item no. 1890V000

travel length 3000 mm

item no. 1891V000

travel length 3400 mm

item no. 1892V000



Low headroom fitting for duo only



Installation examples

# Accessories for all garage door openers



## Transmitter, 4-command

item no. 4020V000

- modern stainless steel version
- retractable control keys prevents **unintentional operation**
- four commands allows radio remote control of e.g. lighting



## Car and wall holder

item no. 4640V000 (without transmitter)

- for transmitter item no. 4020V000 supplied with special adhesive strips, which can be removed without a trace
- the transmitter can easily be inserted and removed (without transmitter)



## Set transmitter, 4-command with car and wall holder

item no. 4650V000

- car and wall holder and transmitter item no. 4020V000 as complete set



## Transmitter, 2-command

item no. 4026V000

- modern 2-command transmitter for a keyring
- includes carabiner for key ring



## Transmitter, 30-command

item no. 4080V000

- for control of up to 30 applications
- with holder also suitable for fitting into forklift and lorries



## Industrial transmitter

item no. 4011V000

- 5-command transmitter
- suitable for commercial use or if a larger housing is desired



## Key switch

item no. 5003-5010V000

- for the activation of the operator by key
- different versions are available for flush or surface-mounting alternatively with or without profile cylinder



## Telecodey

item no. 4071V000

- only your personal code can open your gate, so no key is necessary
- LED-illumination

# erators

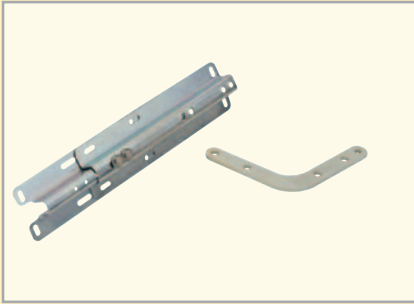

## Universal sectional door fitting, adjustable

item no. 3101

Universal connection set for all sectional doors, very stable and adjustable with shortened curved pushed bar ("boomerang").

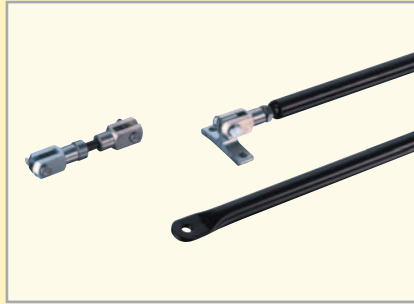

## Wing door fitting

item no. 1501V000

Connection set for the automation of wing doors with SOMMER garage door operators. Suitable for doors with a maximum door width of 2800 mm. Other special dimensions are available on request.



## One-way light barrier, IP 44

item no. 5226V000

One-way light barrier (IP 44) for additional protection of the gate. Range approx. 10 m; 24 V AC/DC; including installation bracket.

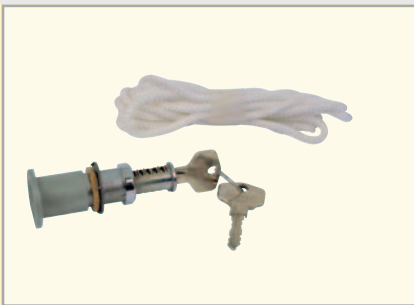

## Release lock

item no. 5036V000

Safe and fast emergency release, e.g. during a power failure, if there is no separate entry to the garage. Suitable for all sectional doors, side-opening sectional doors, lateral shutter doors and wing doors.



## Bowden cable, short

item no. 1612V000

For the emergency release of the door - especially suitable for garages with a turning handle. Available in 0.55/2.30 m lengths.



## Bowden cable, long

item no. 1620V000

For the emergency release of the door - especially suitable for garages with a turning handle. Available in 4.5/5.0 m lengths (when using a tilting arm, an extended drive shaft or a wing door fitting).

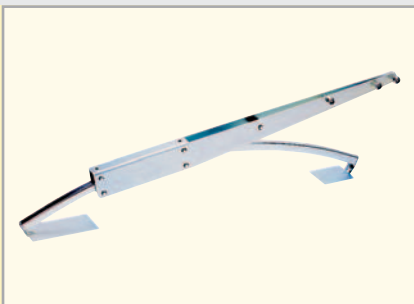

## Bow arm converter

item no. 1500V000

For installation on doors with horizontal guide rail (canopy doors)

ATTENTION:

travel length can be shortened by up to 700 mm!



## Low headroom mounting bracket and fitting for duo only

item 3122v000

- adds even greater flexibility to a unique product



# General

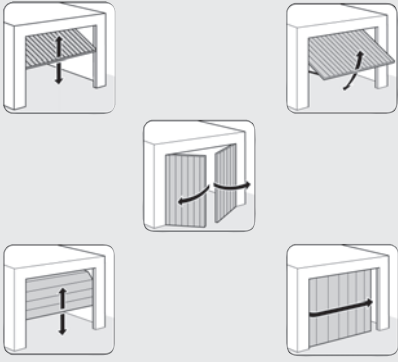

## Application area

SOMMER garage door operators are for the following types of doors:

- sectional doors (segmented doors)
- swing doors
- canopy doors (with special accessory)
- roofline insulated door
- side sectional doors (with special accessory)
- wing doors (with special accessory)

There is a wide choice of accessories for every type of door.

## Warranty

- **5-year SOMMER garage door operators parts guarantee**  
Full details are available on our website [www.sommeruk.com](http://www.sommeruk.com)

## Safety

- SOMMER garage door operators switch off safely and quickly when encountering an obstacle. **Your family and vehicles are thus completely protected.**
- SOMMER garage door operators are constantly tested with doors from nearly all manufacturers by independent test institutes, and the security is documented in accordance with legal guidelines and standards.
- SOMMER garage door operators are certified with **more than 950 doors / operator combinations** e.g. with doors of Henderson, Hörmann, Novoferm, Teckentrup, Normstahl, Guttomat, Günther, Belutec, Heroal, Lakal, Feldmann and many others.

View our current reference list on: [www.sommer.eu](http://www.sommer.eu)

## Radio control system

All door operators can be controlled via a hand transmitter. The SOMMER radio control system has the following features:

- **secure transmission** on frequency FM 868.8 MHz
- **security** due to the Somloq Rolling Code system that is effective against code trapping
- **a radio system for everything**

with your SOMMER transmitter you can also control many other devices in and around the home.



## TÜV, RAL

- SOMMER is certified under ISO 9001
- our garage door operators are tested to TÜV/GS standards with certification
- SOMMER garage door operators are tested to RAL Gütegemeinschaft and reach the **highest test category**

## Technology

- The SOMMER operator system with its travelling motor is unique and patented worldwide. There is no moving endless chain or toothed belt, therefore no wear on parts, such as deflection pulleys. Additionally the gear is released. **This increases the durability of the operator.**
- A self-locking motor prevents your garage door from being pushed open. **An additional mechanical locking device in the rail is not necessary!**
- During a power failure the simple emergency release cable ensures that you can open and close the door.

# marathon

## Benefits of the marathon operation system:

- **Accident prevention**
  - electronic regulated force measurement with DPS - dynamic power system
- **Regulated soft run**
  - no loss of force
- **Low power consumption**
  - due to toroidal transformer
- **Connection**
  - for light barrier, safety contact strip, red traffic light and warning light
- **Automatic close function**

More technical details are on the back of this brochure.

### marathon 550 SL

travel length 2600 mm  
item no. 4200V000

travel length 3400 mm  
item no. 4220V000

### marathon 800 SL

travel length 2600 mm  
item no. 4400V000

travel length 3400 mm  
item no. 4420V000

### marathon 1100 SL

travel length 2600 mm  
item no. 4450V000

travel length 3400 mm  
item no. 4470V000

- fast chain tension
  - fast, secure and easy installation with standard tools

- powder-coated rail

- accessories:  
safety contact strip,  
light barrier

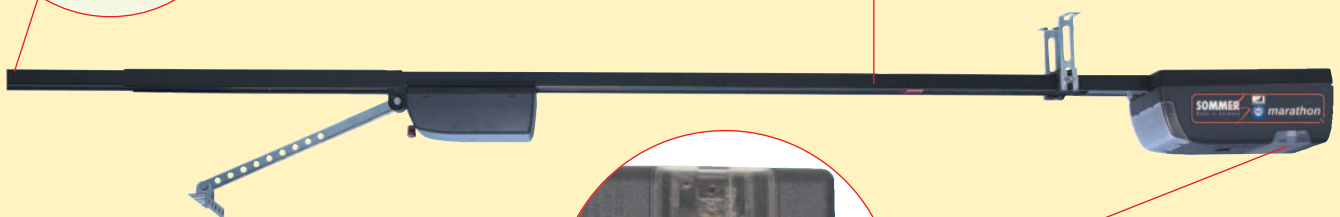
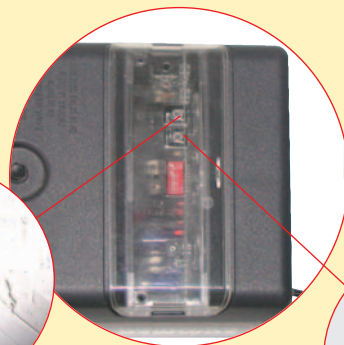

# SOMMER

## Home Automation

www.sommer.eu

additional products:



radio control system



swing gate operators



sliding gate operators



roller and awning drives



aluminium doors

www.groke.de

## Overview of technical data

garage door operators	duo vision 500 / 650 / 800	marathon 550 SL / 800 SL / 1100 SL
travel length - standard - extendable	2.600 mm ●	2.600 mm ●
max. traction and compressive force according to RAL-GZ 740	500 N / 650 N / 800 N	550 N / 800 N / 1100 N
max. speed	150 / 180 / 130 mm/s	180 / 130 / 130 mm/s
nominal power, standby	~ 7 W / ~ 2 W / ~ 2 W	~ 2 W
emergency release from inside, incl. SVS	●	●
motor protection via microprocessor, incl. power and temperature monitoring	●	●
power-saving ring-core transformer	- / ● / ●	●
power supply	AC 220 - 240 V, 50 - 60 Hz, 50 - 60 Hz	AC 220 - 240 V, 50 - 60 Hz
plug-in motor control unit	●	●
fully automatic force reading / recognition of obstacles incl. dynamic power system (DPS)	● ●	● ●
connection for warning light	●	●
24 V output (regulated 0,1 A)	●	●
selective early warning option	●	●
selective backjump option	●	●
soft run option (without loss of force via ramp)	●	●
safety connection for opener contact	●	●
adjustable safety connection functionality	●	●
connection for slip-door facility in the motor bogie unit	●	●
connection for the TorMinal	●	●
counter for operation cycles	■	■
precise drive direction control (OPEN / CLOSE)	●	●
adjustable partial door opening	●	●
door status display	-	■
quantity of radio channels	2	2
quantity of control inputs	1 / 2 ▲	2
quantity of safety inputs	1	2
evaluation 8,2 kOhm integrated	-	●
evaluation safety edge system	-	■
automatic close mode, adjustable	-	●
connection for red traffic light	-	●
floating relay output with programmable function	-	■

<sup>1</sup> for swing doors and sectional-horizontal-doors please follow the values in the installation instructions  
 ■ only in connection with TorMinal ● yes ▲ without safety connection



Sommer Door & Gate Automation UK  
 3 Sterling Park  
 Bleriot Way  
 Clifton Moor  
 York  
 YO30 4WU

Tel: 01904 476330 • Fax: 01904 476331  
 email: info@sommeruk.com  
 www.sommeruk.com